

N100C

**COIL-FED PNEUMATIC NAILERS
CLAVADORAS NEUMÁTICAS ALIMENTADAS POR ROLLO
CLOUEURS PNEUMATIQUES À ENROULEMENT**

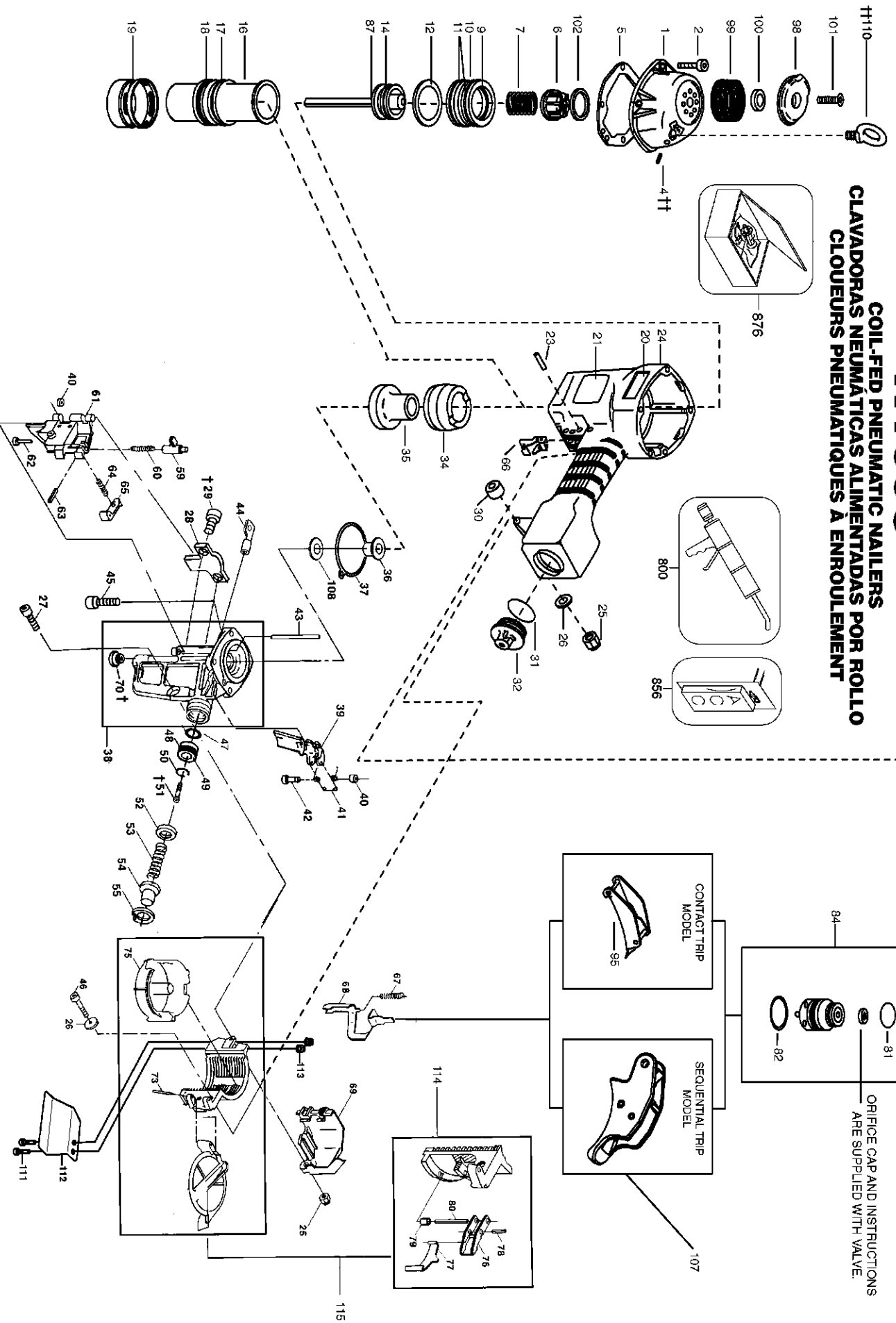

ORIFICE CAP AND INSTRUCTIONS ARE SUPPLIED WITH VALVE.

CONTACT TRIP MODEL

SEQUENTIAL TRIP MODEL

† Screw to feed piston rod with Loctite #271, available as part 951325; Loctite 271 Packet
†† Assemble these threaded components with Loctite #242, available as part 951385.

Parts List for N100C-1 Type 0

| Item Number | Part Number | Description | Qty Required |
|-------------|-------------|----------------------|--------------|
| 1 | N100140A | CYLINDER CAP | 1 |
| 2 | MSC6100-25 | SCREW-SHCS-M6X1.00X2 | 4 |
| 4 | MSS6100-6P | SCREW-CUPSSS-M6X1.00 | 1 |
| 5 | N100131 | SEAL- CYLINDER CAP | 1 |
| 6 | N86132 | PISTON STOP | 1 |
| 7 | 854017-S | SPRING-COMPRESSION | 1 |
| 9 | MRG051531 | O-RING-2.028X.122 | 1 |
| 10 | 105578 | HEAD VALVE (SERVICE | 1 |
| 11 | 851538 | O-RING-2.675X.116 | 1 |
| 12 | N86125 | HEAD VALVE SEAL | 1 |
| 13 | N100116 | MAIN PISTON | 1 |
| 14 | 851539 | O-RING-2.039X.253 | 1 |
| 16 | N90111 | CYLINDER SLEEVE | 1 |
| 17 | RG273710 | O-RING-2.737X.103 | 1 |
| 18 | N100128 | SEAL- CHECK | 1 |
| 19 | N100317 | LOWER SLEEVE | 1 |
| 20 | 113220 | LABEL-BOSTITCH | 1 |
| 21 | 159912 | LABEL-WARNING-COIL N | 1 |
| 23 | 102549 | PIN-SPECIAL SPIROL M | 1 |
| 24 | N90110 | FRAME | 1 |
| 25 | MHE6100-100 | NUT-ESN M6X1 | 2 |
| 26 | MPW6.3 | WASHER-PWN M6 | 2 |
| 27 | MSC6100-35 | SCREW-SHCS-M6X1.00X3 | 1 |
| 28 | N100113 | CONTACT ARM RETAINER | 1 |
| 29 | MSC6100-12 | SCREW-SHCS-M6X1.00X1 | 2 |
| 30 | N70143 | BUSHING-RUBBER | 1 |
| 31 | 850235 | O-RING-1.487X.103 | 1 |

Parts List for N100C-1 Type 0

| Item Number | Part Number | Description | Qty Required |
|-------------|-------------|----------------------|--------------|
| 32 | 103651 | CAP-END | 1 |
| 34 | N100129 | BUMPER- OUTER | 1 |
| 35 | N100130 | BUMPER- INNER | 1 |
| 36 | N100103 | DRIVER-GUIDE | 1 |
| 37 | 106294 | SEAL-NOSE | 1 |
| 38 | 105836 | ASSEMBLY-NOSE & WEAR | 1 |
| 39 | N100112 | FEED PAWL | 1 |
| 40 | 854004 | WASHER-RUBBER-7 | 2 |
| 41 | N80120 | SPRING-TORSION | 1 |
| 42 | N50087 | PIN-SPECIAL(STEP) | 1 |
| 43 | N90106 | PIN-DOOR HINGE | 1 |
| 44 | N80121 | ROD-FEED PISTON | 1 |
| 45 | MSC8125-30 | SCREW-SHCS M8X30 | 1 |
| 46 | MSC6100-40 | SCREW-SOC. HD. CAP M | 1 |
| 47 | MRG009824 | O-RING-.386X.094 | 1 |
| 48 | 851384 | O-RING-.987X.103 | 1 |
| 49 | N80128 | PISTON-FEED | 1 |
| 50 | LW14.2 | WASHER-1/4 HI COL LO | 1 |
| 51 | MSC6100-16 | SCREW-SHCS-M6X1.00X1 | 1 |
| 52 | N80123 | BUMPER-FEED PISTON | 1 |
| 53 | N80122 | SPRING-COMPRESSION | 1 |
| 54 | N80124 | COVER-FEED PISTON | 1 |
| 55 | 851383 | RING-RETAINING METRI | 1 |
| 56 | MRG004216 | O-RING-.165X.063 | 1 |
| 59 | N70150 | LATCH DOOR | 1 |
| 60 | 854013 | SPRING,CMPRSN. | 1 |
| 61 | N100101 | DOOR | 1 |

Parts List for N100C-1 Type 0

| Item Number | Part Number | Description | Qty Required |
|-------------|-------------|----------------------|--------------|
| 62 | N90107 | CHECK PAWL STUD | 1 |
| 63 | MPP030012 | PIN-SPIROL | 1 |
| 64 | 854011 | COMPRESSION SPRING | 1 |
| 65 | N70149 | PAWL CHECK | 1 |
| 66 | N70145 | GUIDE-ARM | 1 |
| 67 | N90103 | SPRING-COMPRESSION | 1 |
| 68 | N100106 | CONTACT ARM | 1 |
| 69 | N100114 | CONTACT ARM GUARD | 1 |
| 70 | N100120 | BUSHING-WEAR | 1 |
| 73 | UB5130 | PIN-SPIROL 1/4 X 1 7 | 1 |
| 75 | N80103 | BOTTOM-CANISTER | 1 |
| 76 | 107455 | LATCH-CANISTER | 1 |
| 77 | N80108 | SPRING-FLAT | 1 |
| 78 | UB2110.4 | PIN-ROLL 1/8 X 5/8 | 1 |
| 79 | N80106 | SPACER-LATCH | 1 |
| 80 | UB2126 | PIN-ROLL 1/8 X 1 5/8 | 1 |
| 81 | 86459 | O-RING | 1 |
| 82 | MRG019824 | O-RING-.780X.094 | 1 |
| 84 | TVA6 | KIT-TRIGGER VALVE | 1 |
| 87 | N100117A | ASSEMBLY-DRIVER/PIST | 1 |
| 95 | CNTK2 | KIT-CONTACT TRIP CON | 1 |
| 98 | N100134A | COVER-EXHAUST | 1 |
| 99 | N100136 | MUFFLER- EXHAUST | 1 |
| 100 | N100138 | SPACER- MUFFLER | 1 |
| 101 | MSC8125-28 | SCREW-SHCS M8X28 | 1 |
| 102 | N100137 | RING- BUMPER | 1 |
| 107 | SEQ6 | KIT-SEQUENTIAL | 1 |

Parts List for N100C-1 Type 0

| Item Number | Part Number | Description | Qty Required |
|-------------|-------------|----------------------|--------------|
| 108 | N100126 | URETHANE WASHER | 1 |
| 110 | 851756 | HANGER | 1 |
| 111 | MSC5080-16 | SCREW-SHCS-M5X0.80X1 | 2 |
| 112 | 103031 | GUARD-NAIL | 1 |
| 113 | MHE5080-100 | NUT-NYLON M5X.80 | 2 |
| 114 | 121632 | ASSEMBLY-BRACKET | 1 |
| 115 | 121635 | ASSEMBLY-CANISTER | 1 |
| 800 | 100679 | LUBE (1LB.CAN) | 1 |
| 800 | 100653 | LUBE (2CC) | 1 |
| 876 | 9R195579 | DEBRIS SHEILD KIT | 1 |