



# ROLAIR®

SCHEMATIC FOR MODELS

5715K17

6820K17D

6715K17

3095K18

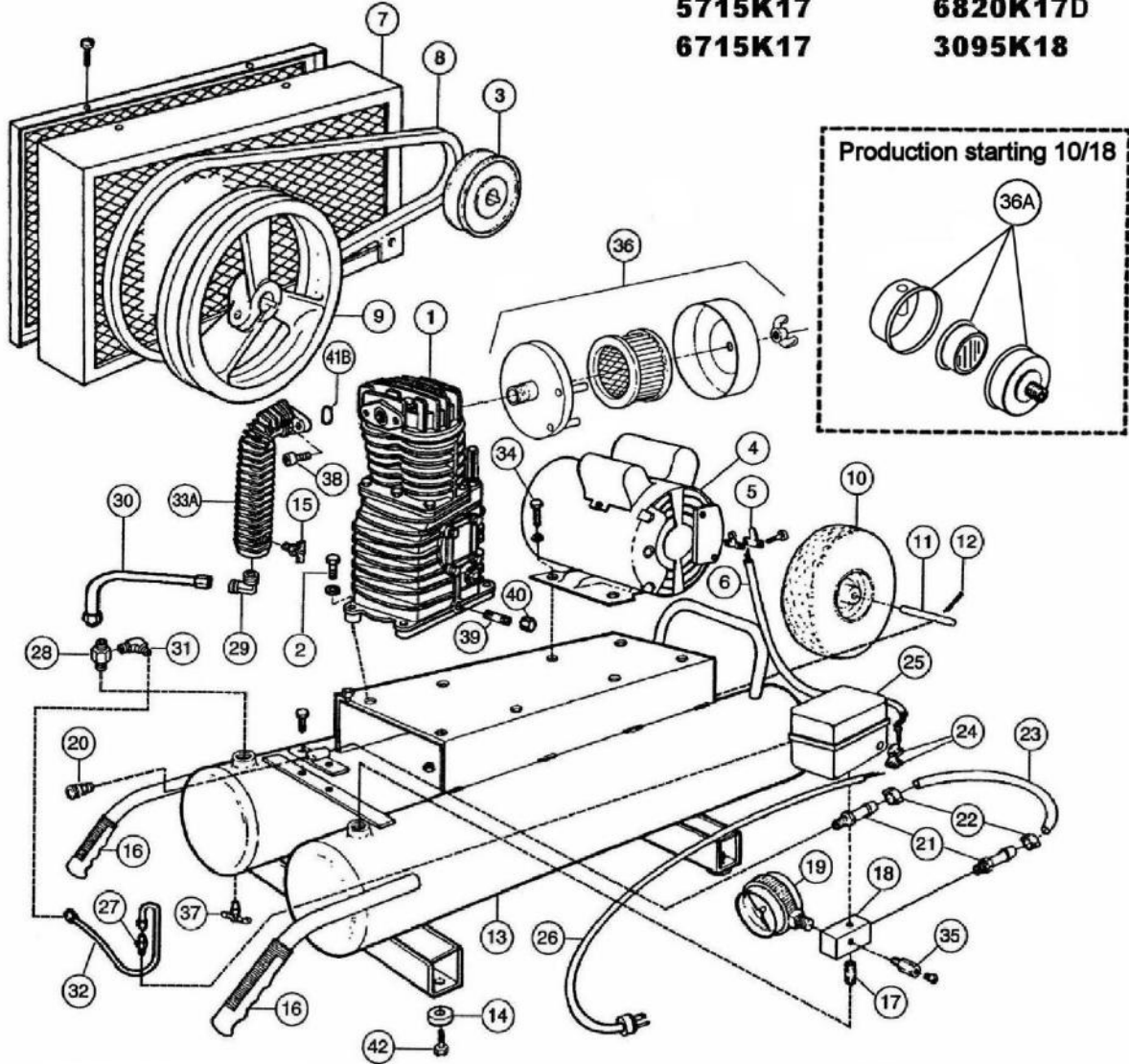

### Optional Accessories

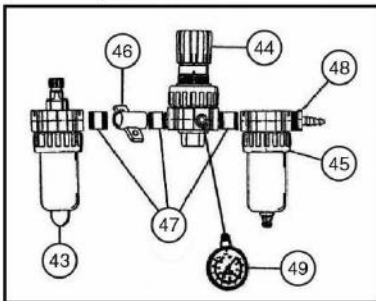

### Production Prior to February 2000

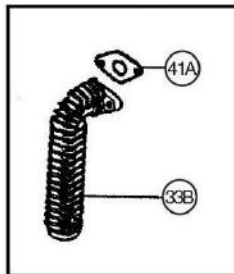

### Dual Control (DC) Components

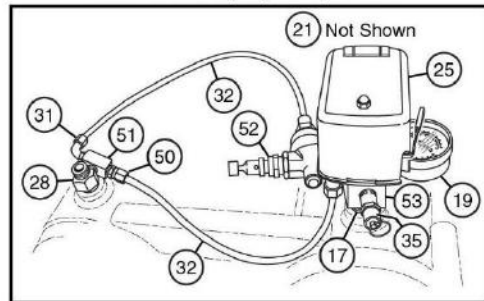

Schem #	Description	Part #	Qty.	Schem #	Description	Part #	Qty.
1	Twin Cylinder Pump With Flywheel	PMP12K17CH	1	28	Check Valve	CV4X4T-A175	1
	Twin Cylinder Pump With Flywheel – Model 3095K18 Only	PMP12K18CH	1	29	Safety Valve (1/8"***)	SRV0125A175	1
2	Bolt	MIS10023	4	30	Brass Elbow	BRELO500X050039	1
				31	Discharge Tube	SPECIFY MODEL	1
3	Motor Pulley	Specify Model	1	32*	Brass Elbow	BRELO250X012539	1
4	1.5 HP Motor – Models 5715K17 & 6715K17	MTRC101	1	32*	1/4" Nylon Tubing – 15.6" - Models 5715K17, 6715K17 & 6820K17	178D	1.3'
	1.5 HP Motor w/Dual-Voltage Switch	MTRC102	1		Brass Nut	BRNT0250	2
	2 HP Motor – Model 6820K17	MTRD103	1		Brass Sleeve	BRSL0250	2
	3 HP Motor – Model 3095K18	MTRD103	1		Brass Ring	BRRG0250	2
					1/4" Copper Tubing – 18" - Model 3095K18	CTUBE14	1.5'
					Brass Nut	BRNT0250	2
5	Box Connector	161A	2	33A	Aftercooler	3290146ACH	1
6	Cord	173A	1	33B	Aftercooler	USE 3290146ACH	1
7	Belt-Guard (Base & Cover)	BG566ASY	1	34	Bolt	MIS10022	6
	Belt-Guard Cover	NLA	1	35	Safety Relief Valve	SRV0250A165	1
8	Belt	Specify Model & SN	1	36	Intake Filter Assembly (before 10/18)	FS14050	1
9	Flywheel	31007280CH	1		Filter Element for FS14050	431	1
10	Foam-Filled Flat-Free Tire	WLS50	1	36A	Intake Filter Assembly (after 10/18)	FS10052	1
11	Axle	181	1		Filter Element for FS10052	433	1
12	Cotter Pin	181A	2		37	Drain Valve	132BV
13	Twin Tank Assembly	Specify Model & SN	1	38	Bolt	37302530CH	2
14	Rubber Foot	219	4	39	Nipple	BLNP0250X1500	1
15	Drain Valve	132	1	40	Cap	BLCA0250	1
16	Handle Grip	328	2	41A	Gasket	30501490CH	1
17	Nipple	BLNP0500X1500	1	41B	O-Ring	30502510CH	1
18	Aluminum Block Manifold**	154	1	42	Screw	MIS10008	4
19	Gauge – Tank	GA0250200GC	1		<b>(Accessories)</b>		
20	Quick Disconnect (Optional)	309A	1	43	Lubricator	LUB0375	1
21	Brass Coupler	BRCP0375X0375H12	2	44	Regulator	REG0375	1
22	Hose Clamp	177A	2	45	Filter	FIL0375	1
23	3/8" Rubber Hose – 16"	178A	1.34'	46	Accessory Bracket	210	1
24	Box Connector	161	1	47	Nipple	BLNP0375X1500	3
				48	Brass Coupler	BRCP0375X0375H12	1
25	Pressure Switch	PS2020M	1	49	Gauge - Line	GA0250200GC	1
	Pressure Switch – Model 3095K18 Only	PS4040	1		<b>(Optional DC Components)</b>		
26	Cord w/110V Plug - Models 5715K17, 6715K17 & 6820K17	170	1	50	Brass Straight	BRST0250X012538	1
	Cord with 220V Plug - Model 3095K18	175	1	51	Brass Tee	BRTE0125	1
27	Pressure Switch Relief Valve	PS2020RV	1	52	Dual Control Pilot Valve	131B2	1
	Pressure Switch Relief Valve – Model 3095K18 Only	PS4040RV	1	53	Dual Control Manifold	154D	1

As an added safety measure, belt driven models built after August 1, 2015 include additional safety valve on check valve.

\*Note: Nylon & Copper Tubing are sold by the foot; may be ordered in bulk lengths.

\*\*Order part #154D if unit is built with dual controls.

\*\*\*Safety valve not shown but may be ordered separately.